

THE SUGAR BEET CO OP

MEMBER
MEETING &
THANKSGIVING
TOAST



2014 Sugar Beet Co-op Highlights

- secured initial financing
- secured 10 year lease
- held first annual member meeting
- hired Project Lead
- hired General Manager
- received \$500k TIF commitment
- completed store design



Snapshot for November 23, 2014

- 800 members
- \$165k in member equity
- \$505k in member loans
- \$760k in traditional financing*
- \$500k in TIF commitment*

**contingent upon raising \$800,000 in member loans and equity*





In Progress for 2014

- raise \$130k through
 - membership shares
 - member loans
- increase membership by 50 per month
- secure construction permits from Village of Oak Park
- order refrigeration
- begin build-out JAN 1, 2015



2015 Timeline

January begin build-out
 fixture construction



February start hiring
 vendor relationships
 begin marketing

March train staff
 finish build-out
 stock store
 soft opening



April Grand Opening!!

South Grove Ave

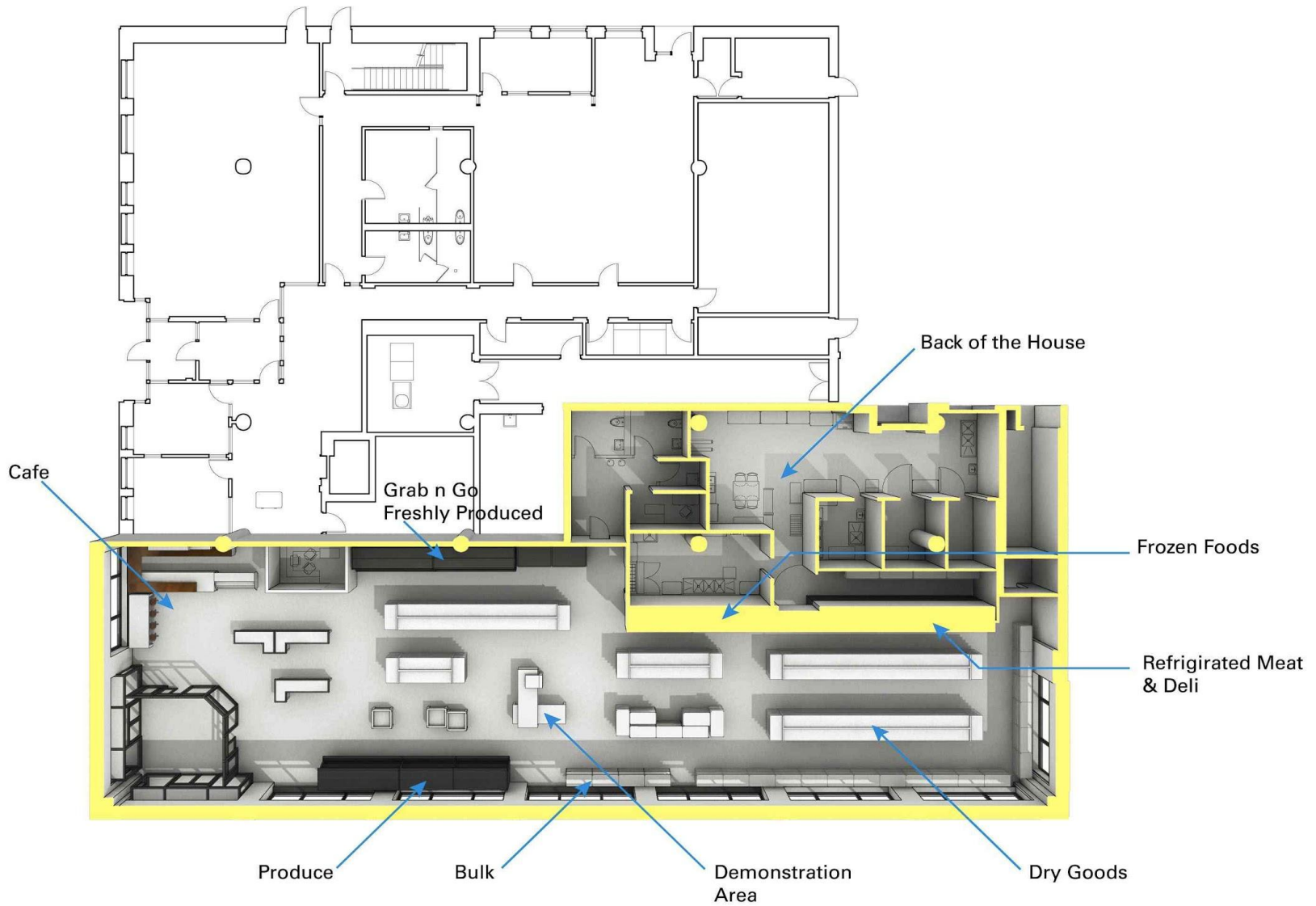

West Madison St





hammersley
ARCHITECTURE

CIVIC PROJECTS LLC



Sugar Beet Co-op Barn Razing
Roscoe, IL November 2, 2014

General Manager, Chris Roland

- committee-led nationwide search
- interviewed six qualified candidates
- strong financial leadership and success
- co-op management experience
- three rounds of interviews
- hired our top candidate







What can you do?

- **host a coffee at home or with a group**
 - invite friends and neighbors to learn more about the Beet
- **join our Ambassador Team**
 - help at events, with promos
- **make a member loan**
 - need to raise \$130 more - **ALMOST THERE!**
 - support YOUR local business



Member Loan Program

- **choose the amount**
 - **\$1000 and greater**
- **choose interest rate**
 - **0% - 4%**
 - **simple % paid at maturity**
- **choose maturity date**
 - **2022-2025**

Thank you to our Member Lenders

Judith Alexander & Joseph Graber

Amanda Alford

Rachel Pildis & Don Anderson

Melissa & Nick Baker

Cynthia & Daniel Beach

Laurie & Robert Bellmar

Debbie Becker

Gina Orlando & Marty Berg

Julie & Brett Burwell

Elizabeth Celio

Mary Susan & David Chen

Charlene Cliff

Maureen Spain & Kevin Cohen

THE
SUGAR
BEET^{CO}_{OP}

Thank you to our Member Lenders

Aimee Eicher
Mary Eisenlohr
Kristina Entner & Edward Malone
Nicole Donohue
Aimee DeLuca & Chris Dowsett
Ana Garcia & Jim Doyle
Christine & Mark Fisher
Jennifer & Parnell Flynn
Sue Crothers & Bill Gee
Brian Herbstritt
Elizabeth & Christopher Keys
Glynis Kinnan
Lisa Kozinski & Gerard Dysico

THE
SUGAR
BEET^{CO}_{OP}

Thank you to our Member Lenders

Karen Steward Nolan & Peter Nolan

Darla & John Patterson

Ellen Wehrle & Rich Pokorny

Christine & Drew Mitchell

Julie & Scott Moller

Cheryl & Anthony Muñoz

Alison & Chris Ohlhoff

Marcia & Paul Schattauer

Mary Jo Schuler

Lynda Jo & Noah Shlaes

Sally Stovall & Richard Alton

Stephanie Thomas

Bill Watson

THE
SUGAR
BEET^{CO}_{OP}

Thank you to our Member Lenders

Sallie & Chuck Wolf
Randi Woodworth
Cathy Yen

Financial Institutions & Family Foundations

Chicago Community Loan Fund
North Country Cooperative Development Fund
Walter Mander Foundation
Manaaki Foundation

THE
SUGAR
BEET^{CO}_{OP}

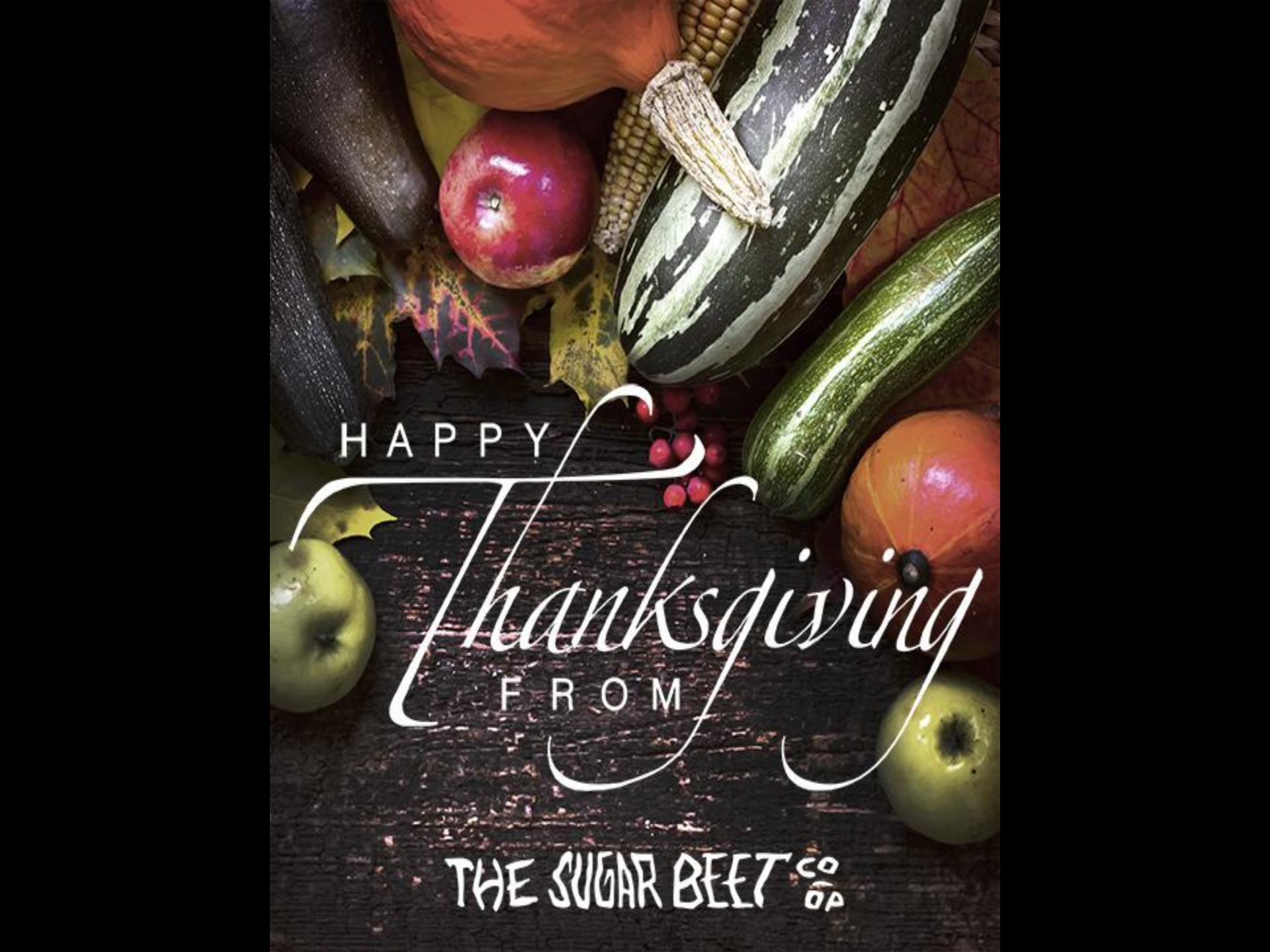

HAPPY

Thanksgiving

FROM

THE SUGAR BEET ^{CO}_{OP}